



Eonian Care Feeding solutions Instruction Booklet



EC-301

Dear parents:

Congratulations on the purchase of your new Eonian Care Feeding Solutions.

FEATURES:

- Eonian Care Feeding Solutions are BPA free PP material and food-grade silicone—nothing else.
- Soft silicone teat mimics the natural lactating breast of mothers to retain baby's natural sucking pattern and promotes easy latch-on for babies.
- Soft and angled silicone straw mitigates head tilting, also helps your baby exercise mouth muscles and builds oral strength.
- Built-in anti-colic ventilation hole in all Eonian Care Feeding Solutions range prevents excessive air intake and safeguards baby from tummy upsets.
- Hygiene cap keeps the teats and the straw clean for home or on-the-go.
- Leak proof and easy to clean.
- Steriliser-safe, dishwasher-safe, freezer-safe (magic cup with storage lid only).
- Reusable and neatly stackable: saving space and your budget.
- Transparent design and easy write-on cup: track dates and contents for easy storage
- Comply with European Safety Standard EN14350.

Raising a baby is safe and easier with Eonian Care.

With love,

Eonian Care

2

WARNING—MUST READ BEFORE USE

- Always use this product with adult supervision.
- Keep all components out of reach of children.
- Never use teats as soothers.
- Continuous and prolonged sucking of fluids may cause tooth decay.
- Always check content temperature before feeding.
- Make sure the suction hole and ventilation hole are clear before each use.
- Do not expose the teats directly to the sun or leave the teats in the steriliser longer than suggested.
- Stop using the weakened or damaged content immediately.
- Prevent your child from running or walking while drinking.
- This straw cup is intended for use with light liquid. Do not use it with other liquids, such as soup or broth.
- Do not over tighten the lid on the straw cup.
- Do not microwave food when the storage lid is screwed tight.
- Do not place the storage cups in a hot oven or on any other hot surface.

3

CLEANING AND STERILISING

- Clean and sterilise (steam or boil) all parts before and after each use.
- Wash your hands thoroughly before you touch sterilised items and make sure the surfaces on which you place sterilised items are clean.
- Exercise care when cleaning the contents.
- Carefully clear the suction hole and ventilation hole after each use.
- Teats are recommended to be replaced every two months. Straw cups are recommended to be replaced every three months.
- Dishwasher safe. Use the top shelf only.
- Do not clean the contents with solvents or harsh chemicals.



4

INSTRUCTIONS

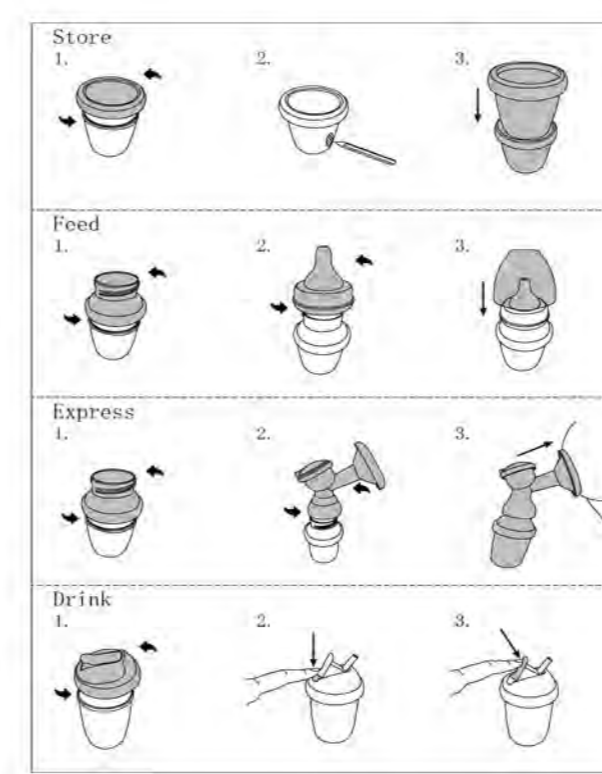

5

VALUE SET INCLUDES

- 3*180ml magic cups
- 3*240ml magic cups
- 6*storage lids
- 2*adaptors
- 1*slow flow teat with screw ring
- 1*fast flow teat X-shape with screw ring
- 1*straw cup top

ESSENTIAL SET INCLUDES

- 1*180ml magic cups
- 1*240ml magic cups
- 2*storage lids
- 1*adaptor

ACCESSORIES

All contents are sold separately in store or online. Please choose a teat with a proper hole size to ensure the ideal feeding experience.

6

ANY QUESTIONS

Eonian Care Customer Service Centre Australia
PO BOX 167
EPWINGTON NSW 1700
T: 02 6986 4180 Monday to Friday: 9:00 – 17:00 (AEST) Close on NSW public holidays.
Email: customerservice@eoniancare.com.au

OR click on www.eoniancare.com.au for more information and support.

7

MILK STORAGE

Breast milk is suggested to be stored in a sterilised container and refrigerated immediately after expression. Our Eonian Care Feeding Solutions set is your one-stop solution to express, store and feed your breast milk effectively.

1. Connect the storage cup with the breast pump using the adaptors provided in the feeding companions set. Screw tight.
2. Start pumping. Do not fill the cup more than the maximum limit (180ml/240ml) to allow space for possible expansion.
3. When finished, switch off the breast pump. Unscrew the cup from the adaptor and remove it from the pump body. Screw the flat cap onto the cup firmly.
4. Alternatively, if you intend to feed your baby with the expressed breast milk within 48 hours, you can assemble a sterilised teat and screw ring onto the adaptor. Seal the teat with the dome cap.
5. Clearly label the bottle with the date and time of expression.
6. Refer to the storage guidelines to store your milk. Remember to choose the coldest part of the refrigerator. Use older breast milk first.

8

STORAGE GUIDELINES FOR BREAST MILK

Breast milk	Room Temperature	Refrigerator	Freezer
Freshly expressed breast milk into a closed container	4–6 hours (28°C or lower), if refrigeration is available store milk there	No more than 48 hours	2 weeks (-15°C) 3 months in a separate compartment (-10°C) 6–12 months in deep freeze (-20°C)
Previously frozen – thawed in refrigerator but not warmed	4 hours or less	24 hours	Do not refreeze
Thawed outside refrigerator in warm water	Use it immediately	No more than 4 hours	Do not refreeze
Infant has begun feeding	Only for completion of feeding, then discard	Discard	Discard

Adapted from National Health and Medical Research Council 2012, Infant Feeding Guidelines. N-NVRC, Canberra p59.

MILK THAWING

- You can thaw milk slowly in the refrigerator. It takes about 12 hours so try putting it in the fridge the night before you need it. Avoid letting milk sit out at room temperature to thaw.
- For quicker thawing, place frozen milk in the water to warm, or use our Eonian Care Electric Steriliser and Bottle Warmer to heat up the frozen milk.
- NEVER microwave breast milk or heat it directly on the stove to avoid loss of vitamins, minerals and other important components.

9



YOUR SMART BABY SOLUTIONS

Specifications are subject to change without notice.
Trademarks owned by Eonian Trading Pty Ltd
All Rights Reserved.

10